

# Instructions for portable planet gear





---

**NOTE:**

This manual must be read and its instructions must be followed when installing, operating and/or performing maintenance on the valve as well as its manual gear or actuator.

---

These instructions are of general nature and do not cover all possible operating scenarios. For more specific guidance on the installation, operation and maintenance of the valve or its suitability for an intended use, please contact the manufacturer.

Vexve Oy reserves the right to make alterations to these instructions.

Vexve Oy is not responsible for damages caused by incorrect transportation, handling, installation, operation or maintenance. Furthermore, Vexve Oy is not responsible for damage caused by foreign objects or impurities.

---

## Warnings and symbols

Ignoring the warnings and symbols may lead to serious injury or equipment damage. Persons authorized to use the equipment must be familiar with the warnings and instructions.

Appropriate transportation, storage and installation as well as careful commissioning are essential to ensure faultless and stable operation.

The following symbols are used in this manual to draw attention to actions essential to ensure the proper use and safety of the device.



---

**Meaning of the symbol: NOTE**

The NOTE symbol is used for actions and functions that are essential for the proper use of the device. Ignoring this symbol may have harmful consequences.

---



---

**Meaning of the symbol: WARNING**

The WARNING symbol is used for actions and functions that, if carried out incorrectly, may lead to injury or equipment damage.

---



**NOTE:**

Gear does not rotate in the opposite direction because of the clip.

Valve from OPEN position to CLOSE position, turn clockwise.

The clip of the gearbox on "R" position, turn clip of the ratchet to right.

If you want to change direction, turn ratchet slightly in order to loose the clip of the gearbox.

Valve from CLOSE position to OPEN position, turn anticlockwise.

The clip of the gearbox on "L" position, turn clip of the ratchet to left.

If you want to change direction, turn ratchet slightly in order to loose the clip of the gearbox.

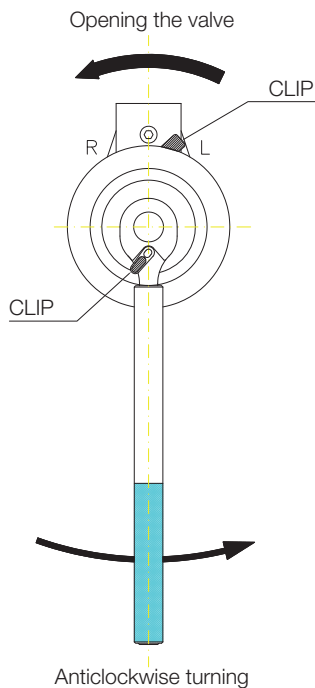
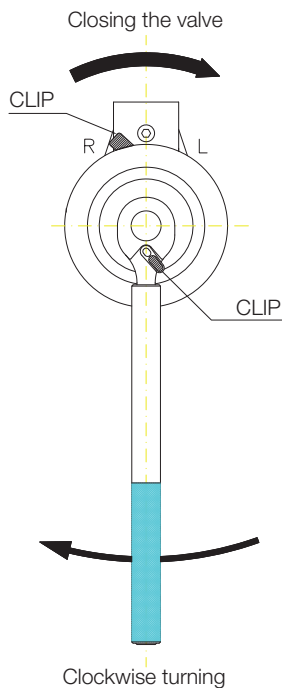

**CAUTION:**

- Don't move ratchet handle by hitting with hammer, or by force.
- Don't use ratchet handle with extension pipe.

# Portable planet gear 287191

The portable planet gears are designed to be used with long stem valves. Planet gear converts the input torque, meaning that the user is able to operate the valve with less torque.

Product number:	287191
Body:	Steel
DN-size:	200–400
Socket:	HEX-50
Max. input (Nm):	490 Nm
Max. output (Nm):	7050 Nm
Gear reduction ratio:	18:1
Weight:	23 kg

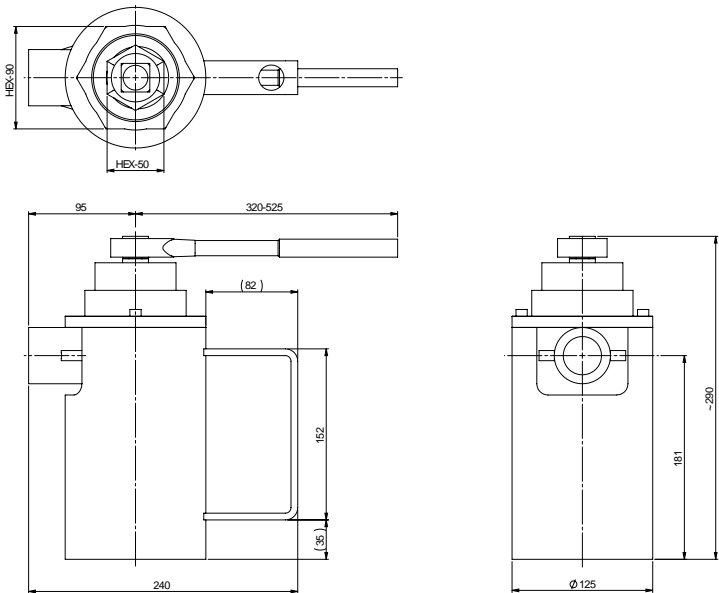

# Portable planet gear 287192

The portable planet gears are designed to be used with long stem valves. Planet gear converts the input torque, meaning that the user is able to operate the valve with less torque.

Product number:	287192
Body:	Steel
DN-size:	100–150
Socket:	HEX-27
Max. input (Nm):	490 Nm
Max. output (Nm):	7050 Nm
Gear reduction ratio:	18:1
Weight	11,3 kg



NOTE: For to operate DN 100–150 long stem valves with planetary gear, valves should be supplied with a mounting flange (HEX-90, 299470) and a retaining ring (299412). Mounting flange and retaining ring can be mounted afterward.

Please contact the manufacturer for more information.

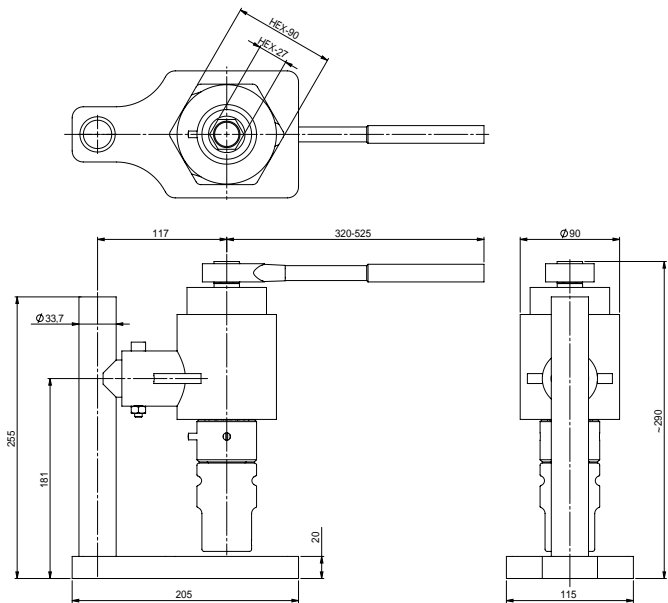







Vexve Oy

Pajakatu 11  
38200 Sastamala  
Finland

Riihenkalliontie 10  
23800 Laitila  
Finland

tel. +358 10 734 0800  
[vexve.customer@vexve.com](mailto:vexve.customer@vexve.com)

[www.vexve.com](http://www.vexve.com)